

American Kennel Club

SIGHTHOUND LURE COURSING – QC Certification, JC TEST, & TRIAL

Event Numbers and Dates

2025098816	2025098817
May 17	May 18
QC, JC and Trial	QC JC and Trial

Held by:

Chintimini Kennel Club

An AKC Member Club



Trial Location:

Billups Ranch

71273 London Rd.

Cottage Grove, Oregon 97424

ON-LINE ENTRIES ONLY

NO DAY OF EVENT ENTRIES - NO PAPER ENTRIES

Saturday 17 May and Sunday 18 May 2025

Entries close 7:00 p.m. May 15, 2025

NO LIMIT on all breed trial stakes

LIMITED ENTRY EVENTS

7 for QCs and Singles Stake and 10 for JCs

	QC Certs. and JC Test	\$25.00
Entry	Trial, First Hound	\$25.00
Fee:	Trial, Any additional hound (same owner)	\$20.00
	Junior Handlers (one hound only)	\$10.00

Use this link to enter and pay entry fees with a credit card

<https://form.jotform.com/ChintiminiKC/may-trial-entries>



Permission has been granted by the American Kennel Club for holding of this event under American Kennel Club Rules and Regulations.

Entry Information

Lure Coursing tests and trials shall be open to eligible breeds one year of age or older. For a complete listing of the breeds eligible to participate in the AKC Lure Coursing program, please visit the AKC website at: www.akc.org/events/lure_coursing/eligible_breeds.cfm. *Breeds italicized in judge assignment tables are not eligible to run for Best in Field.* All eligible dogs must be either individually registered with AKC, recorded with the Foundation Stock Service (FSS), individually registered with a foreign registry organization whose pedigrees are acceptable for AKC registration, or that have been granted a Purebred Alternative Listing (PAL/ILP).

Entry Information

1. Only online entries will be accepted. No day of entries will be accepted.
2. Each E-entry form will allow a dog to be entered in the same class for one or both events. A separate e-entry form must be completed for each dog or if the same dog is to be entered in different classes each day (e.g., singles on Sat and Open on Sun).
3. **If you are entering a QC and want to also enter the trial on the same day, you must complete a second on-line entry form (one for QC and 1 for open or single).** Dogs that pass the QC can run as either an open or single, a dog that doesn't pass the QC will run as a single. We will change the class for QC dogs the day of the trial if they do not pass.
4. Your entry and payment will be confirmed by email provided in the entry form. Note that some confirmation emails to Comcast.net email addresses, may be lost due to the spam filter on this system. This may also happen with other email addresses. If you enter the incorrect email address this will also cause problems.
 - If you do not receive a confirmation email, it may be in your bulk/junk inbox. If you suspect your form was not correct or received for another reason please email luretrial@chintiminikennelclub.com

Refund Policy

1. Refunds will be given for dogs withdrawn before closing (Partial refund, minus processing fees)
2. Refunds will be given for female dogs in season or any dogs who do not pass inspection (partial refund for females in season; full refund for dogs that do not pass inspection)

CHINTIMINI KENNEL CLUB

Officers

President: Sue Pisas

Recording Secretary: Savannah VanWhy

Vice President: Nitza Catino

Treasurer: Nick Pisas

Corresponding Secretary: Eleni Maus

Board: Alexis Jacobson, Bonnie Cooley, and Linda Kornhi

Field Committee

Field Chairman: Bonnie Cooley*, 28311 W Kelly Rd., Benton City WA 99320. reddogfam@yahoo.com,

Field Secretary: Jennifer Weikel*, 16060 Airlie Rd. Monmouth OR 97361. eightsw@gmail.com; 541-760-2818

Lure Operators : Nick Pisas*, Bill Martin, Richard Cooley, Jeremiah Eriksen

Inspection: Tina Graham*; Xochitl Berns

* = **Field Committee Members;** additional committee members are Sue Pisas, Carol West, Kristin Nelson

GENERAL

1. All entries must be one year of age or older on the day of the test or trial.
2. Stakes will be split by public random draw if the entry in any one stake is sufficient to hold two or more five-point majors.
3. In the trial, all hounds will run twice, in trios if possible, or braces, unless excused, dismissed, or disqualified.
4. Hounds not present at the time of roll call will be scratched after a five (5) minute grace period. Each entry will be examined at inspection for breed disqualifications. Bitches in season and lame hounds will be excused. Entry fee for hounds excused, during inspection, for bitches in season, lameness or breed disqualification shall be refunded. Processing fees from Square will be retained for refunds, with the exception of dogs that fail at inspection. Spayed or neutered hounds, without breed disqualifications, may be entered.
5. Electric powered DRAG LURE MACHINES. Lure will consist of white plastic bags.
6. The course will be reversed for the finals.
7. The field committee reserves the right to alter the course plan as required by weather and/or field conditions on the day of the trial.
8. The field committee reserves the right to bar known aggressive hounds from the trial site.
9. There will be a \$5 fine assessed for any loose hound not taking part in the course in progress, or for anybody caught not picking up after their dog or leaving garbage on the field.
10. **NO ONE** will be allowed on the field without the express permission of the field chairman, except the appointed field committee.
11. Anybody exhibiting unsportsmanlike behavior will be excused from the field and may be subject to further disciplinary action.
12. **Control of dogs strictly enforced, on leash at all times except when running. This is a farm with livestock.**
13. **Clean up and carry out all trash. Please pick up all dog feces** and remove with trash or put in receptacle provided at site by porta-potties.
14. **In accordance to the definition of jackets as set forth by AKC only SOLID BRIGHT color jackets will be allowed on the field. Jackets with patterns, names, or similar embellishments will not be acceptable. Plain piping used to finish seams will be allowed**
15. **No substitution of entries will be accepted for any reason at these events. Class changes acceptable the day of the trial (e.g., open to singles) only if the secretary is notified prior to the trial and prior to drawing blankets.**

Health and Safety

As always, the Club will be holding the trial with the safety of our exhibitors, volunteers, and dogs in mind.

By entering these events you are acknowledging the contagious nature of COVID- 19 and voluntarily assume the risk that you may be exposed to or infected by COVID-19 by attending the club's event, and that such exposure or infection may result in personal injury, illness, permanent disability and possibly death.

Photographer

Skinny Dog Photography

www.skinnydogphoto.com

TEST AND STAKES OFFERED

JC Test

Open to all hounds of an eligible breed one year or older on the day of the test. (See AKC Lure Coursing Rules and Regulations for any disqualifications that may apply). A hound running alone shall receive a certification from a Judge on one date and a second certification from a different Judge at a later date, stating that the hound completed a 600-yard course with a minimum of (4) turns. The hound must complete the course with enthusiasm and without interruption.

QUALIFIED COURSER CERTIFICATE

Open to a hound at least 12 months of age running with another hound of the same breed—or another breed with a similar running style. The hound must complete the course with enthusiasm and without interruption, sufficiently course the lure and not course the Testing Hound. The judge will certify that the Qualifying Hound ran cleanly and did not appear to present a hazard to the Testing Hound at any point in the qualifying course. This certificate is required to enter a hound in an Open Stake. The handler presenting the Qualifying Hound **SHALL BE RESPONSIBLE FOR PROVIDING THE TESTING HOUND FOR THE QUALIFYING COURSE.** The club will create a QC certificate at the trial for dogs that pass.

IT IS STRONGLY RECOMMENDED THAT EVERY QUALIFYING HOUND HAVE BEEN RUN PREVIOUSLY IN PRACTICE AND THAT TO THE HANDLER'S SATISFACTION RUNS CLEANLY AND KEENLY WITH OTHER HOUNDS.

OPEN

Open to all hounds that have obtained an AKC Qualified Courser certificate or have an American Sighthound Field Association (ASFA) qualification certificate. This requirement will be waived for hounds that have earned a Field Championship title from the Canadian Kennel Club (CKC). CKC Field Champions must submit a copy of their title certificate to the host club when they enter their first AKC Open Stake. This copy must be included when the results of the trial are sent to AKC. Dogs with ASFA qualification certificates must also provide a copy to be submitted to AKC. Championship points earned from the Open Stake will only count toward a Field Champion title. Hounds that have earned an AKC Field Championship title are not eligible to enter the Open Stake.

VETERANS

Open to all hounds which are eligible to enter Open or Special Stakes and meet the age requirement for a veteran as established by the breed's parent club- 6 years of age; except Afghan = 7 years; Irish Wolfhounds = 5 years, and Whippets = 7 years. Championship points will be awarded. Points won from the Veteran Stake may count toward either a Field Championship title or Lure Courser Excellent title.

SPECIALS

Open to all hounds that have earned their AKC Championship titles. Championship points earned from the Specials Stake will count toward Lure Courser Excellent titles. Qualifying scores earned from the Specials Stake will count toward a Senior Courser or Master Courser title.

SINGLE STAKES

Open to all hound breeds approved to participate in AKC Lure Coursing trials. Hounds with breed disqualifications are eligible to enter. Hounds entered in the Singles Stake shall not be allowed to enter the regular stakes (open, specials or veteran) at the same event.

BEST IN FIELD (BIF) will be offered

Open to all AKC Recognized Breed Best of Breed winners with the exception of FSS breeds.

RIBBONS & PRIZES

JC & QC Tests: Dark green ribbon for qualifying score.

TRIAL: Ribbons for 1st—5th place. Rosettes for Best of Breed and Best In Field. SATURDAY'S & SUNDAY'S Best In Field Award is an Aluminet sun shade

ALL HANDLERS **MUST BE PRESENT** FOR INSPECTION AND ANNOUNCEMENTS

Any dog not present for inspection will be considered absent.

All dogs will be inspected each day. QC dogs must be reinspected if they are entered in trial for the same day.

Field committee and listed volunteers may have dogs inspected early.

EVENT SCHEDULE

Note slightly later start time on Saturday to allow for travel time and earlier start time on Sunday

EVENT	HOURS	INSPECTION	START OF RUNS
QC TEST	8:00 AM—COMPLETION	7:30—8:30	9:00AM Saturday; 8:30 AM Sunday
JC TEST	8:00 AM—COMPLETION	7:30—8:30	9:15 Saturday and 8:30 Sunday, to follow QC runs
TRIAL	8:00 AM—COMPLETION	7:30—8:30	9:30AM Saturday and 9:00 AM Sunday, to follow QC and JC runs

EVENT JUDGES

Name	Number	Address
Judge #1 Michael Savage	ZJ228	PO Box 141737 Spokane Valley, WA 99214
Judge #2 Michael Small	ZH050	4356 Hope Ct. Las Cruces, NM 88011

Judge Assignments:

(assignments may be modified depending on entries; any changes will be posted day of trial)

Saturday (two judges each breed)	Michael Savage	All breeds and Singles Stakes
	Michael Small	All breeds, JC and QC Tests
Sunday (one judge each breed)	Michael Savage	Afghan, Azawakh, Basenji, Borzoi, Cirneco Dell 'Etna, Ibizan Hound, Norrbottenspets, Peruvian Inca Orchid, Thai Ridgeback, Whippet, JC and QC Tests
	Michael Small	Irish Wolfhound, Italian Greyhound, Greyhound, Pharaoh Hound, <i>Portuguese Podengo Pequeno</i> , <i>Portugese Podengo Grande</i> , <i>Portugese Podengo Medio</i> , Rhodesian Ridgeback, Saluki, Scottish Deerhound, Sloughi, <i>Singles Stakes</i> .

Breeds in italics are not eligible to run in Best in Field; Run order will be posted the morning of the trial

VETERINARIAN

Forest Valley Vet Clinic (Friday & Sat AM only). 2555 Mosby Creek Road, Cottage Grove, Or. 541-942-9132 . Call first, identify yourself as being from the Lure Coursing event. This vet has regular office hours 8am to 6pm Friday and 8am to 1 pm Saturday.

Directions: go north on London Road 14 miles to I-5 freeway. Turn right to enter freeway northbound. Take first off-ramp, Exit 174. Turn left on Row River Road. Turn right on Thornton Road, then left on Mosby Creek Road. The Clinic is the second building on right.

Call Emergency Vet Hospital after 1pm Saturday and all day Sunday. 103 West Q Street, Springfield, Or. 541-746-0112 (provides 24-hour service)

COURSE LAYOUT: Billups Ranch

Saturday: (920 yds; field will be shortened to 600 yds for tests)

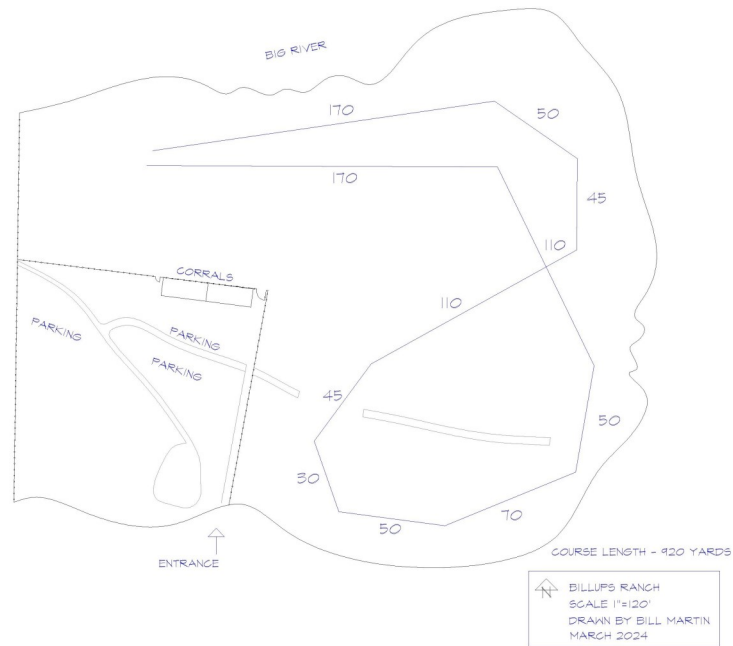

Sunday: (815 yds; field will be shortened to 600 yds for tests)

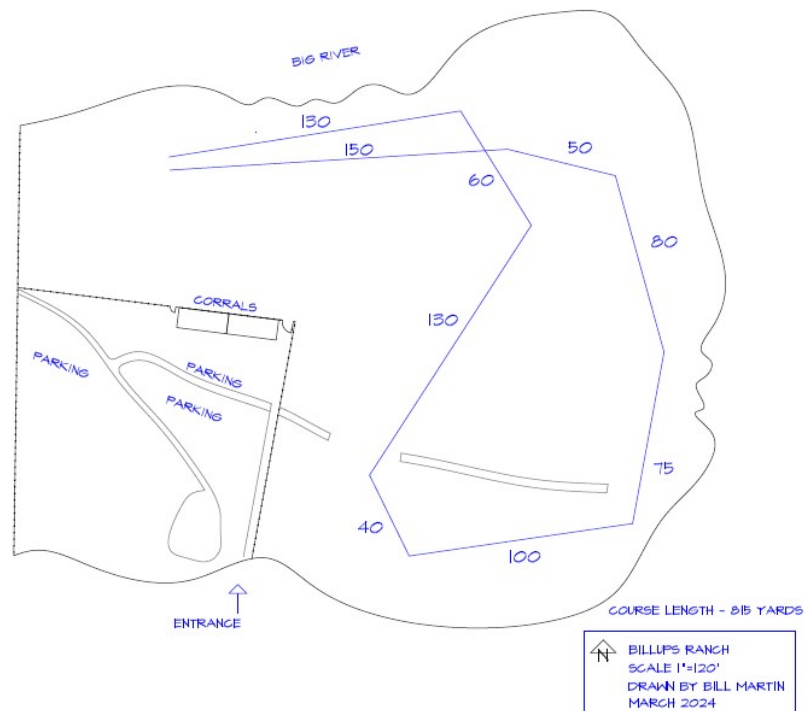

FIELD CONDITIONS: Fully fenced pasture grass field with natural barriers and field fencing. Parking will be on grass field. Water is available on site.

DIRECTIONS TO SITE: 71273 London Rd., Cottage Grove OR 97424

Traveling South : Exit Cottage Grove, 6th Avenue Exit 172. Turn east. Follow 6th Avenue down the hill and veer toward the left. Continue using directions below.

Traveling North: Exit the I-5 at 170 going North. The 170 off-ramp takes you over a bridge to the west side of the freeway and runs parallel for a couple of miles. Turn right on Latham Road at the Weyerhaeuser Lumber Mill. Follow Latham until it dead ends at 6th Ave / London Road. Turn Right on London Road and follow remaining directions below.

*Sixth Avenue has now become London Road. Follow London Road to mile marker 13. The mile markers are small signs on the side of the road. Right after mile marker 13, you cross a bridge. About 1/2 mile past the bridge, there are 3 mail boxes on the right side of the road. Directly opposite the mail boxes, is a gravel road. Turn left onto that road. Follow the gravel road about 1/4 mile to the Y intersection. Take the left part of the Y. Immediately after the Y, is a driveway on the left, do not take that. Follow the road straight until you come to a stop sign and the Whippet Watch sign. Turn left immediately after the stop sign and follow the gravel road down to the field. The pasture gate will be open, and we will be running right next to the barn. Parking is right next to the barn, or next to the horse pens depending on the number of people who show up. If it is wet, please park on the gravel drive, as the ground in horse pasture can get very soft.

Hospitality Plan

Please plan to bring your own snacks, water and lunch. Coffee and light snacks will be provided.

There are no amenities near the trial site, so come prepared for the day!

On-Site Camping

Dry camping available, but space is limited for small (**less than 30'**) RV's and tent camping only. Parking on grass field with access in/out down gravel road. No waste dump is available. Participants with RV's must contact Ann Billups, 541-767-3653 by Monday May 12; abillups@mac.com. If conditions are wet, directions will be given for how to get in/out of the field safely—be sure to follow the directions!

Note

The Billups' Ranch is 15 miles from I-5. No cell phone coverage at site. Please plan accordingly.

ACCOMMODATIONS

(call to confirm that they are still dog-friendly)

- Best Western Cottage Grove Inn: 1601 Gateway Blvd, Cottage Grove, 97424 - (541) 942-1000
- Cottage Grove Inn: 845 Gateway Blvd, Cottage Grove, 97424 - (541) 942-9747
- Comfort Inn and Suites: 247 Melton Rd, Creswell, OR 97426 — (541) 895-4025
- Multiple hotels also available in Springfield OR, about 12 miles north of Cottage Grove
- R/V and Camping: Cottage Grove Lake, Pine Meadows Campground (541) 942-8657

RAFFLE

SIGHTHOUND TREASURES GALORE RAFFLE!

Ann Billups has donated whippet & saluki items from that past 40 years.
Plus there will be other items for dogs and humans.



Canine Massage offered by Jennifer Pumpelly
@ Hands 4 Hounds Massage
LMT, CSAMT OR #12000
971-732-6470

Website is Hands4houndsmassage.com

30 min sessions will be offered @ \$50.00

Cash or check only for this trial

I have 20+ yrs experience as a human Massage Therapist , and treating dogs since 2021. I Specialize in injury treatment, and I bring the same passion and knowledge to help my canine patients. I offer Myofascial Release, Trigger Point Therapy, Relaxation, and Stretching. I Look forward to seeing you and your dog.